

Hollow output shaft

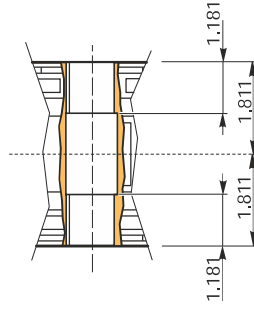

Mounting positions

M1 (B3)

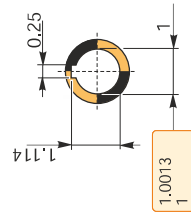
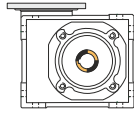

M2 (V6)

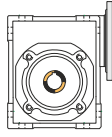

M3 (B8)

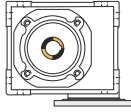

M4 (V5)

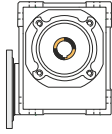

M5 (B7)

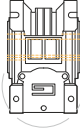

M6 (B6)

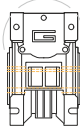

Oil quantity [quarts]

Lubricant type: this gear unit is delivered life lubricated

Direction of rotation

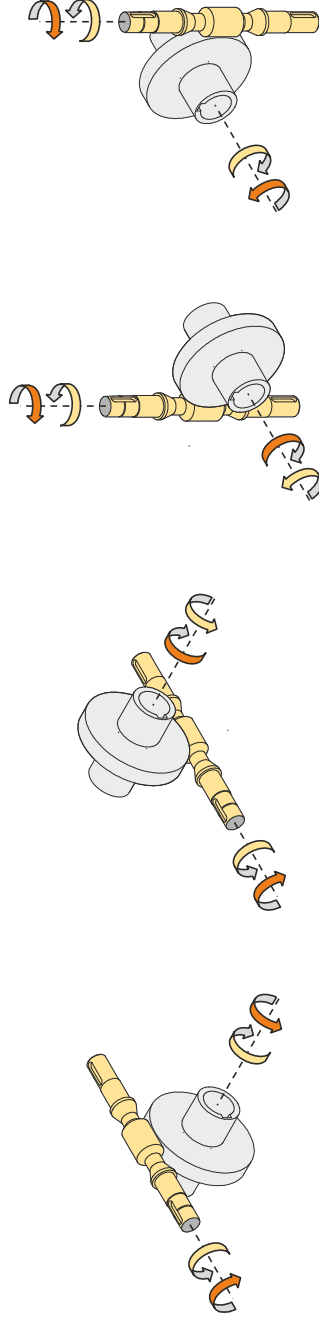

Weight

Gear unit [lb]

7.7

Gearing data

Number of starts

Lead angle

Pressure angle

3

18° 23'

20°

Backdriving

Static back-driving

Quick back-driving

Dynamic back-driving