

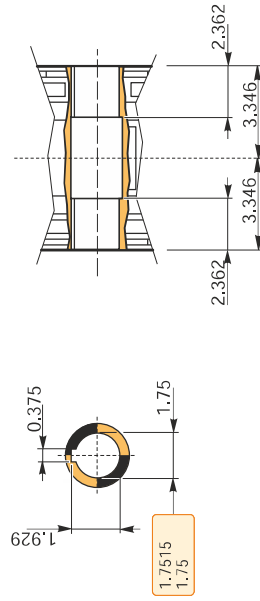

**Hollow output shaft**

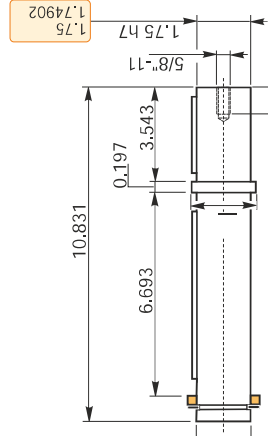

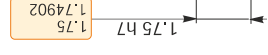
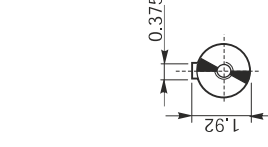
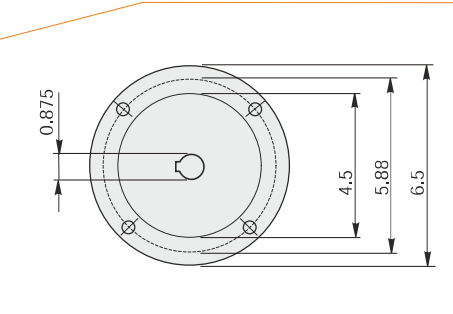
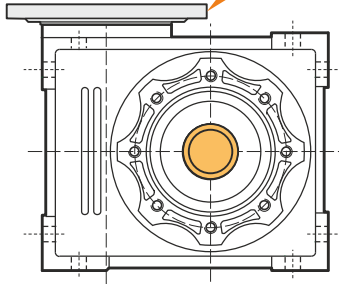
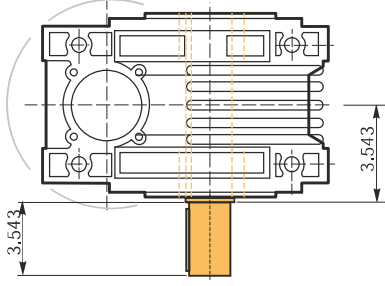
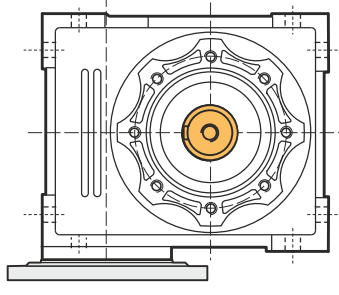

Output shaft is delivered as loose accessory

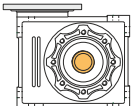
### Mounting positions

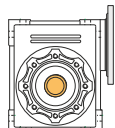
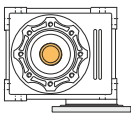
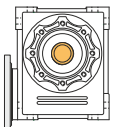
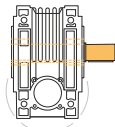
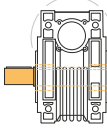
Model	Image	Weight [lb]	Oil quantity [quarts]
M1 (B3)		3.487	
M2 (V6)		3.698	
M3 (B8)		4.755	
M4 (V5)		3.698	
M5 (B7)		3.487	
M6 (B6)		3.698	

Lubricant type: this gear unit is delivered life lubricated

### Direction of rotation

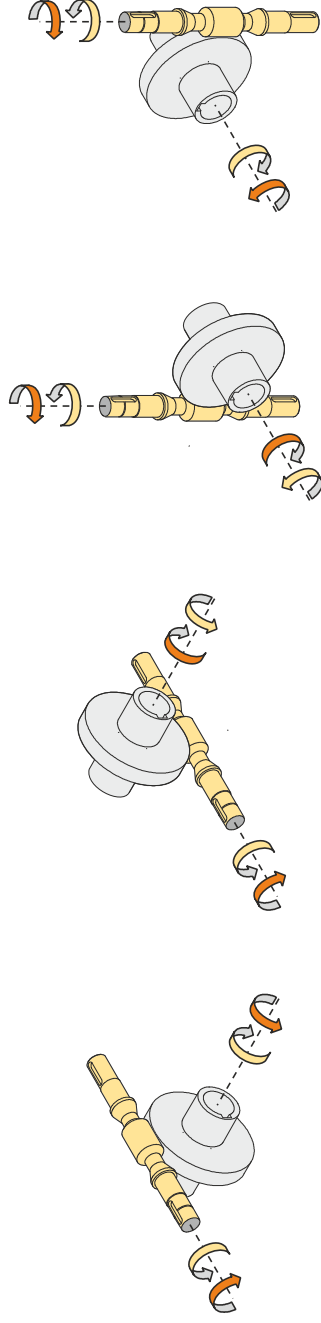

### Weight

Gear unit [lb]

99.2

### Gearing data

Number of starts  
Lead angle  
Pressure angle

2  
13°47'  
20°

### Backdriving

Variable static self-locking  
Quick back-driving in case of vibrations  
Dynamic back-driving